

GENERAL NOTES

This drawing is © 2014 PTE architects  
 Use figured dimensions only DO NOT SCALE.  
 All dimensions are in millimetres unless noted otherwise  
 All levels are in metres above ordnance datum unless noted otherwise  
 This drawing must be read in conjunction with all other relevant drawings and specifications from the Architect and other consultants  
 If in doubt, ask

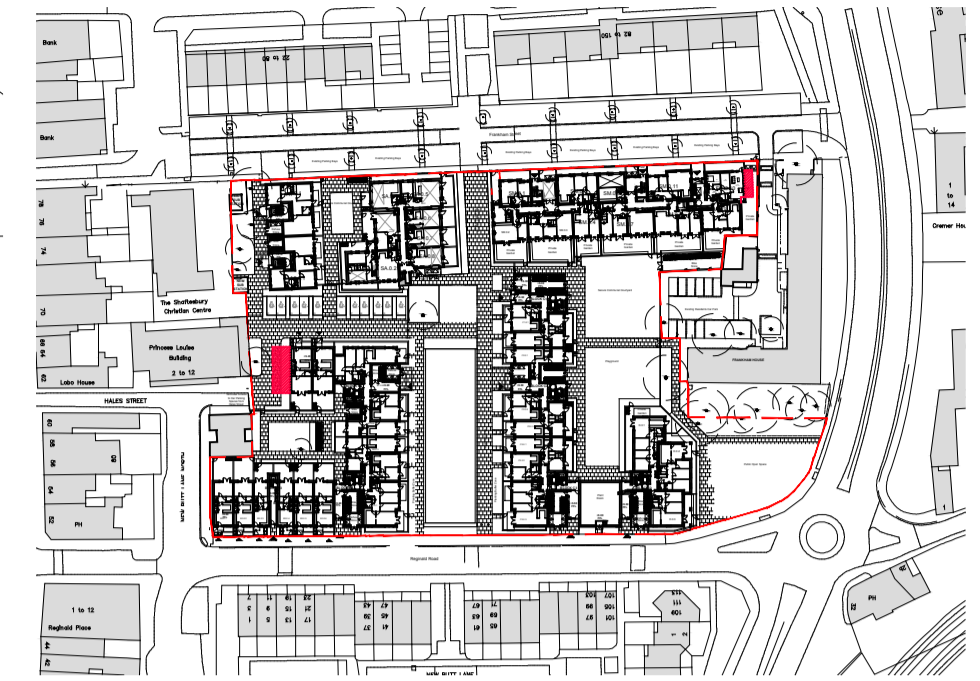

- EXISTING TREES
- NEW TREES
- BOX HEDGE
- LOW LEVEL PLANTING
- GRASS
- HARD LANDSCAPING
- AREA OF REMOVED/ALTARED BUILDING (POST PLANNING SUBMISSION)

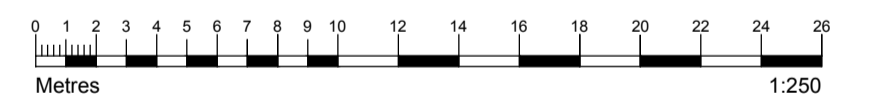
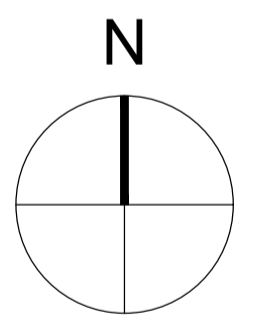

REV	DATE	DESCRIPTION	DRAWN	AUTH'D
L	15.09.2017	Tree adjacent to Princess Louise Building retained	AT	TP
K	07.12.2016	Trees adjacent to Princess Louise Building amended to suit residents and BDP information	AT	BT
J	22.09.2016	Removed areas highlighted	AT	TP
H	04.08.2016	School extension entrance restored to original planning layout	AT	BT
G	02.08.16	Label added	SH	BT
F	28.07.16	Alterations to main school extension	SH	BT
E	01.07.16	Alterations to B1	AT	BT
D	20.05.16	D.0.2 and D.0.3 Revision of entrances to suit GLA comments	LW	BT
C	29.04.16	Revision of entrances to suit GLA comments	RM	BT
B	17.12.15	Planning Drawing issue	AT	BT
A	08.12.15	Unit references updated.	AT	BT
-	30.11.15	Planning issue	AH	BT

PLANNING

Diepfecker Wharf  
 38 Gresham Street  
 London N1 6JX  
 020 7336 7777  
 forename.surname@pte.co.uk  
 @ptearchitects  
 www.pollardthomasedwards.co.uk

**Pollard  
 Thomas  
 Edwards**

PROJECT	JOB NO.	DRAWN	AUTH'D	SCALE	DATE
GIFFIN STREET SOUTHERN SITES FRANKHAM STREET	14-029	LS	BT	1:250@A1	JUL 14
General Arrangement Ground Floor Site Plan	029_PL_100				L

E:\14-029 GIFFIN STREET SOUTHERN SITES\0147 A-D PLANNING\PRINT\PLANNING\029\_PL\_100.DWG

